

S.NO	CATALOG NUMBER	D	W
1	BFGBS182618	16.5 [419]	26 [660]
2	BFGBS183018	16.5 [419]	30 [762]
3	BFGBS184818	16.5 [419]	48 [1219]
4	BFGBS223018	20.5 [521]	30 [762]
5	BFGBS223618	20.5 [521]	36 [914]
6	BFGBS166018	14.5 [368]	60 [1524]
7	BFGBS186018	16.5 [419]	60 [1524]
8	BFGBS224818	20.5 [521]	48 [1219]
9	BFGBS226018	20.5 [521]	60 [1524]
10	BFGBS226618	20.5 [521]	66 [1676]
11	BFGBS227818	20.5 [521]	78 [1981]
12	BFGBS228418	20.5 [521]	84 [2134]
13	BFGBS164818	16.5 [419]	48 [1219]

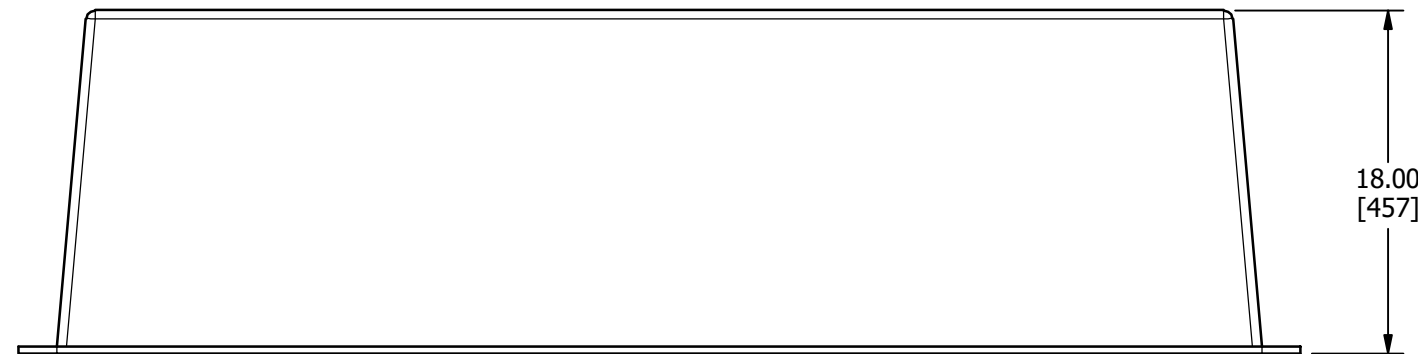
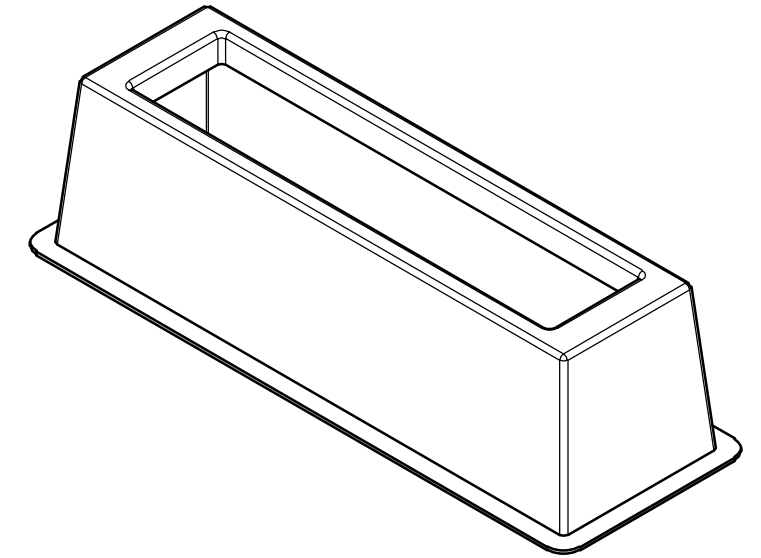

NOTES:

- MATERIAL: FIBERGLASS
- NON-CORROSIVE AND NON-CONDUCTING BASE/FOUNDATION FOR MOUNTING SECTIONALIZING CABINETS, FUSING CABINETS OR SIMILAR APPLICATIONS
- ALLOWS AMPLE SPACE FOR TRAINING CABLES
- EASILY DRILLED TO ACCEPT MOUNTING HARDWARE
- ELIMINATES ANY CONCERN WITH CORROSION DEGRADATION COMMON WITH METAL FOUNDATIONS
- THE BASE IS MANUFACTURED FROM DURABLE, NON-CORROSIVE, THERMOSET POLYESTER RESIN REINFORCED WITH FIBERGLASS
- THE BASE IS MAINTENANCE FREE
- INTERNAL OR EXTERNAL RIBS PROVIDE STRUCTURAL INTEGRITY AND UNIFORM NESTING
- THE BASES CAN BE RE-STACKED AND TRANSPORTED WITHOUT BINDING

					TO ORDER CMC PRODUCTS UNITED STATES 1-513-860-4455 CANADA 1-800-361-6975 MEXICO 011-52-722-265-4400 FOR PRODUCT INFO www.cmclugs.com	DRAWN BY: TS 04-20-20	NAME OF PART: FIBERGLASS CABINET BASES / FOUNDATIONS	CAT. NO.: SEE TABLE
						CHECKED BY:	DWG NO: UB22107048-S (CHARTED)	B
A	NEW DRAWING CREATED				04-20-20	TS		
REV.	DESCRIPTION	ECN	DATE	INIT.	DRAWING NOT TO SCALE		SHEET NO: 1 OF 1	

THIS INFORMATION IS PROPRIETARY TO CONNECTOR MFG. CO. AND IS NOT TO BE DISCLOSED OUTSIDE OF CONNECTOR MFG. CO. WITHOUT A CONFIDENTIALITY AGREEMENT

TempEmbed.bmp

CONNECTOR MANUFACTURING CO.

HAMILTON, OHIO

